

Figure 2.3 - Overall Sampling Grids for the Newly Reclaimed Area

LEGEND:

- Western Vehicular Tunnel Sampling Grid (100x100m)
- Eastern Vehicular Tunnel Sampling Grid (100x100m)
- Airport North Fire Station Sampling Grid (100x100m)
- Terminal 2 Concourse Sampling Grid (100x100m)
- Western Portion of T2 Concourse Sampling Grid (100x100m)
- APM/BHS Tunnel and Ancillary Building with Piled Foundation Sampling Grid (100x100m)
- All sampling layer(s) passed RBRG limit(s)
- Sampling layer(s) with testing parameter(s) exceeding RBRG limit(s)

(0) No sample taken as the marine sediment was not encountered within the final excavation level

(1) One sample taken from the depth of 0-3m

(2) One sample taken from the depth of 0-3m and 3-6m

(3) One sample taken from the depth of 0-3m, 3-6m and 6m to the bottom of the marine sediment to be excavated

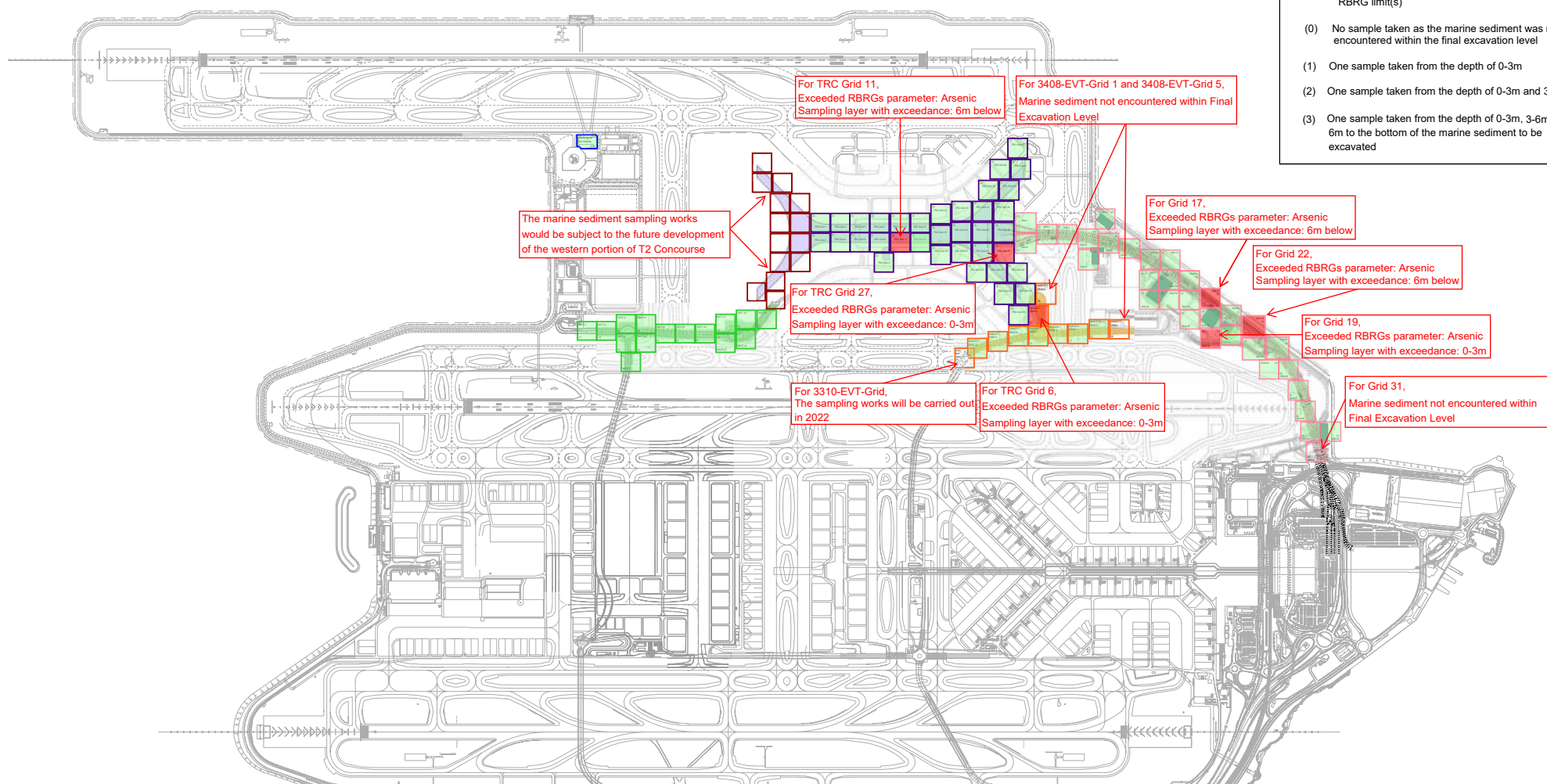

The marine sediment sampling works would be subject to the future development of the western portion of T2 Concourse

For TRC Grid 11, Exceeded RBRGs parameter: Arsenic Sampling layer with exceedance: 6m below

For 3408-EVT-Grid 1 and 3408-EVT-Grid 5, Marine sediment not encountered within Final Excavation Level

For Grid 17, Exceeded RBRGs parameter: Arsenic Sampling layer with exceedance: 6m below

For Grid 22, Exceeded RBRGs parameter: Arsenic Sampling layer with exceedance: 6m below

For Grid 19, Exceeded RBRGs parameter: Arsenic Sampling layer with exceedance: 0-3m

For Grid 31, Marine sediment not encountered within Final Excavation Level

For 3310-EVT-Grid, The sampling works will be carried out in 2022

For TRC Grid 6, Exceeded RBRGs parameter: Arsenic Sampling layer with exceedance: 0-3m

For TRC Grid 27, Exceeded RBRGs parameter: Arsenic Sampling layer with exceedance: 0-3m