

Figure 2.3 - Overall Sampling Grids for the Newly Reclaimed Area

LEGEND:

- Western Vehicular Tunnel Sampling Grid (100x100m)
- Eastern Vehicular Tunnel Sampling Grid (100x100m)
- Airport North Fire Station Sampling Grid (100x100m)
- Terminal 2 Concourse Sampling Grid (100x100m)
- Western Portion of T2 Concourse Sampling Grid (100x100m)
- APM/BHS Tunnel and Ancillary Building with Piled Foundation Sampling Grid (100x100m)
- Pile foundation area for East and Landside Fire Station
- Pile foundation area for Airport District Police Operation Base
- Sampling layer(s) passed RBRG limit(s) where marine sediment was excavated
- Sampling layer(s) with testing parameter(s) exceeding RBRG limit(s) where marine sediment was excavated

(0) No sample taken as the marine sediment was not encountered within the final excavation level

(1) One sample taken from the depth of 0-3m

(2) One sample taken from the depth of 0-3m and 3-6m

(3) One sample taken from the depth of 0-3m, 3-6m and 6m to the bottom of the marine sediment to be excavated

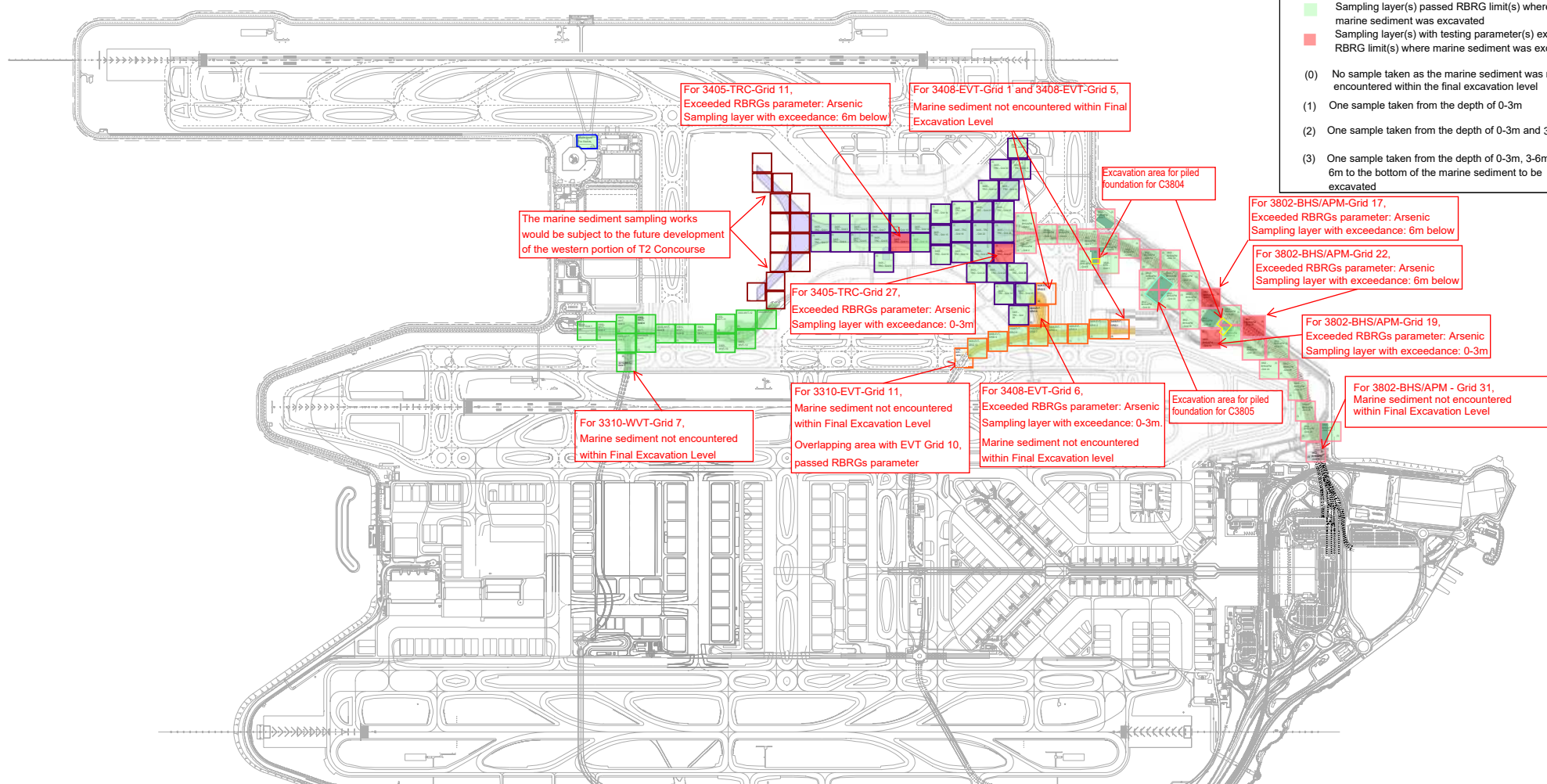

Notes:

1. Measurements are based on mean system.
2. All data are for reference only. Further work should be done.
3. All data are for reference only.
4. The Contractor shall be responsible for the safety, the protection and maintenance of any existing structure.
5. The Contractor shall be responsible for the safety and protection of any existing structure.
6. The Contractor shall be responsible for the safety and protection of any existing structure.
7. The Contractor shall be responsible for the safety and protection of any existing structure.
8. The Contractor shall be responsible for the safety and protection of any existing structure.

Drawn	Checked	Issue	Drawn	Checked	Issue	Drawn	Checked	Issue

Approval		
Signature	Date	Post
	28/12/19	

