





C. Identified Potential Land Contaminated Source of Emergency Power Supply System No.1 (EPSS1) in SCAP

Appendix C Identified Potential Land Contaminated Source of Emergency Power Supply System No.1 (EPSS1) in SCAP

Reference ID	Description
BH1	A 2,500 L underground fuel tank
BH3	A 450 L above-ground fuel tank at Emergency Generator Room
BH2	53 m-in-length underground fuel pipelines connecting the 2,500 L underground fuel tank (i.e. BH1) and the 450 L above-ground fuel tank (i.e. BH3)
BH4	An emergency generator at Emergency Generator Room (above-ground)

LEGEND:

-  Curvature Sampling Point - Indicative Sampling Point Selection of Underground Pipeline Trench of EPSS1 (i.e. BH2) in SCAP
-  Additional Sampling Point - Indicative Sampling Point Selection of Underground Pipeline Trench of EPSS1 (i.e. BH2) in SCAP
-  Scope of Contamination Assessment Report (CAR) for T2 EPSS1 Vol. 1
-  Scope of the CAR for T2 EPSS1 Vol. 2 (this CAR)

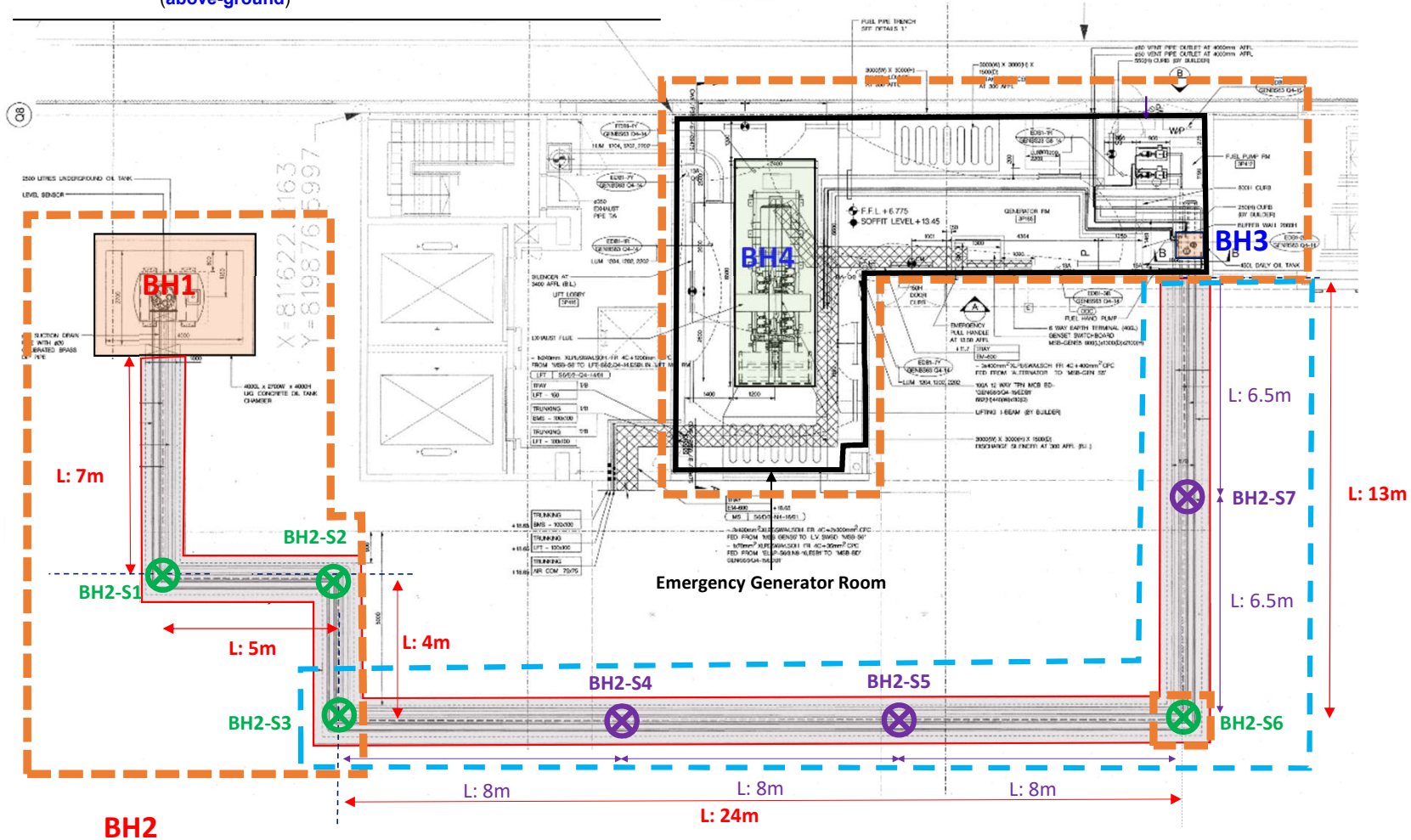

Total Length: Approx. 53 m