



## **D. Indicative Sampling Point Selection of BH1 and BH2 - BH2-S1, BH2-S2, BH2-S3, BH2-S6 in SCAP**

Appendix D.1 Indicative Sampling Point Selection of **BH1** and **BH2 - BH2-S1, BH2-S2, BH2-S3, BH2-S6)** in SCAP - **BH1**

Sample	Sampling Point Selection Strategy
Sand	0.5 m, 1.5 m Below Ground Surface and bottom level inside the concrete chamber
Soil	Right underneath concrete chamber

**Legend:**

-  Sand Sampling Point
-  Soil Sampling Point

Depth of concrete chamber (~3.9 m)

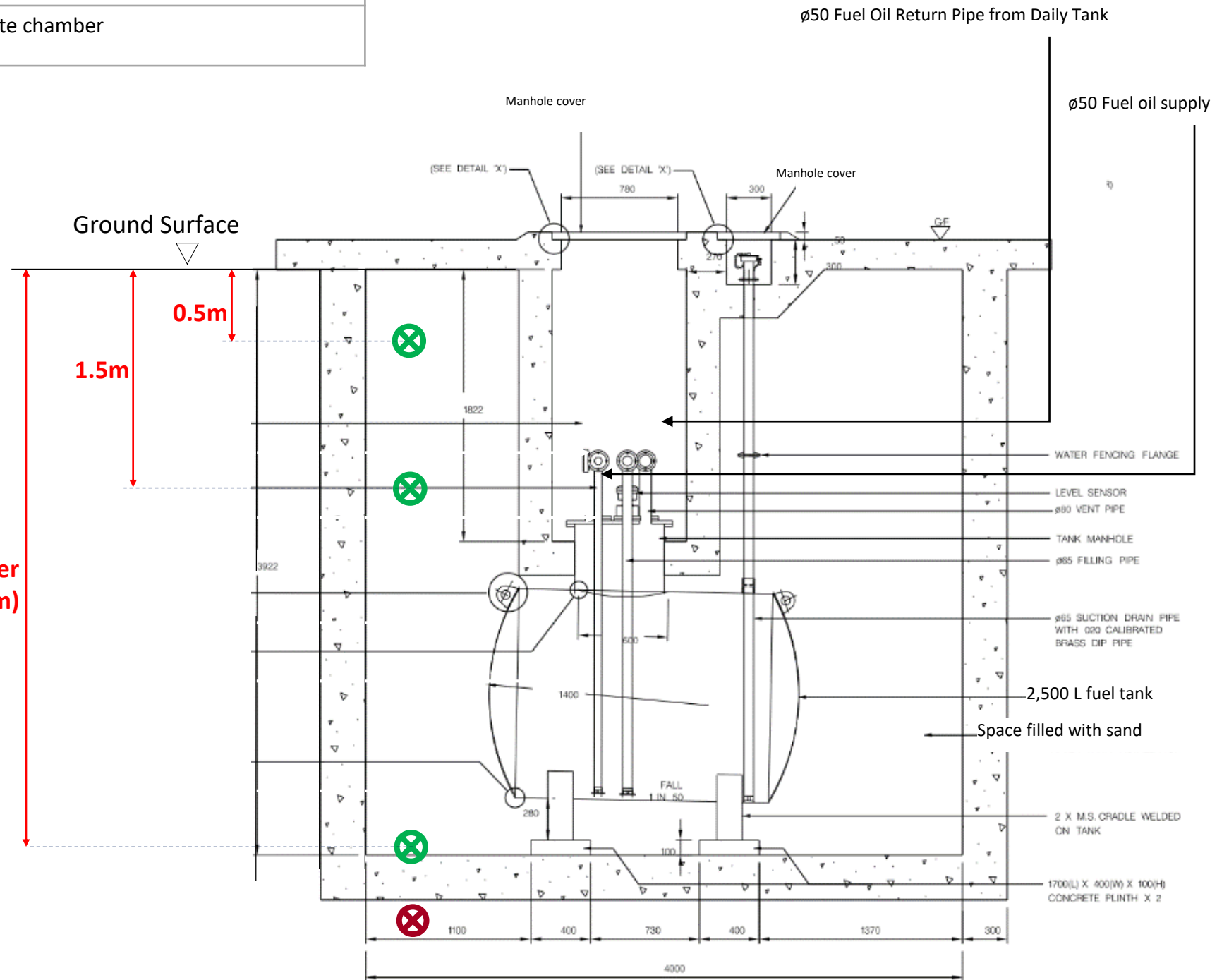

Indicative Sampling Point Selection of 2,500 L Underground Fuel Tank of Emergency Power Supply System No.1 (i.e. **BH1**)

Appendix D.2 Indicative Sampling Point Selection of **BH1** and **BH2 - BH2-S1, BH2-S2, BH2-S3, BH2-S6**) in SCAP - **BH2 - BH2-S1, BH2-S2, BH2-S3**

Annotation of Sampling Point	Type of Sampling Point (Curvature/ Additional)	Sample		Remarks
		At the level of fuel pipelines (Within Concrete Trench)	Right underneath concrete trench	
BH2-S1	Curvature	Sand	Soil	Under the scope of this CAR
BH2-S2	Curvature		Soil	
BH2-S3	Curvature		Soil	
BH2-S6	Curvature		Soil	
BH2-S4	Additional	Sand	-	<b>NOT</b> under the scope of this CAR (BH2-S4, BH2-S5 and BH2-S7 will be presented in Vol. 2 of the CAR for T2 EPPS1.)
BH2-S5	Additional		-	
BH2-S7	Additional		-	

**LEGEND:**



Curvature Sampling Point - Indicative Sampling Point Selection of Underground Pipeline Trench of EPSS1 (i.e. **BH2**) in SCAP



Additional Sampling Point - Indicative Sampling Point Selection of Underground Pipeline Trench of EPSS1 (i.e. **BH2**) in SCAP



Scope of this Contamination Assessment Report (CAR)

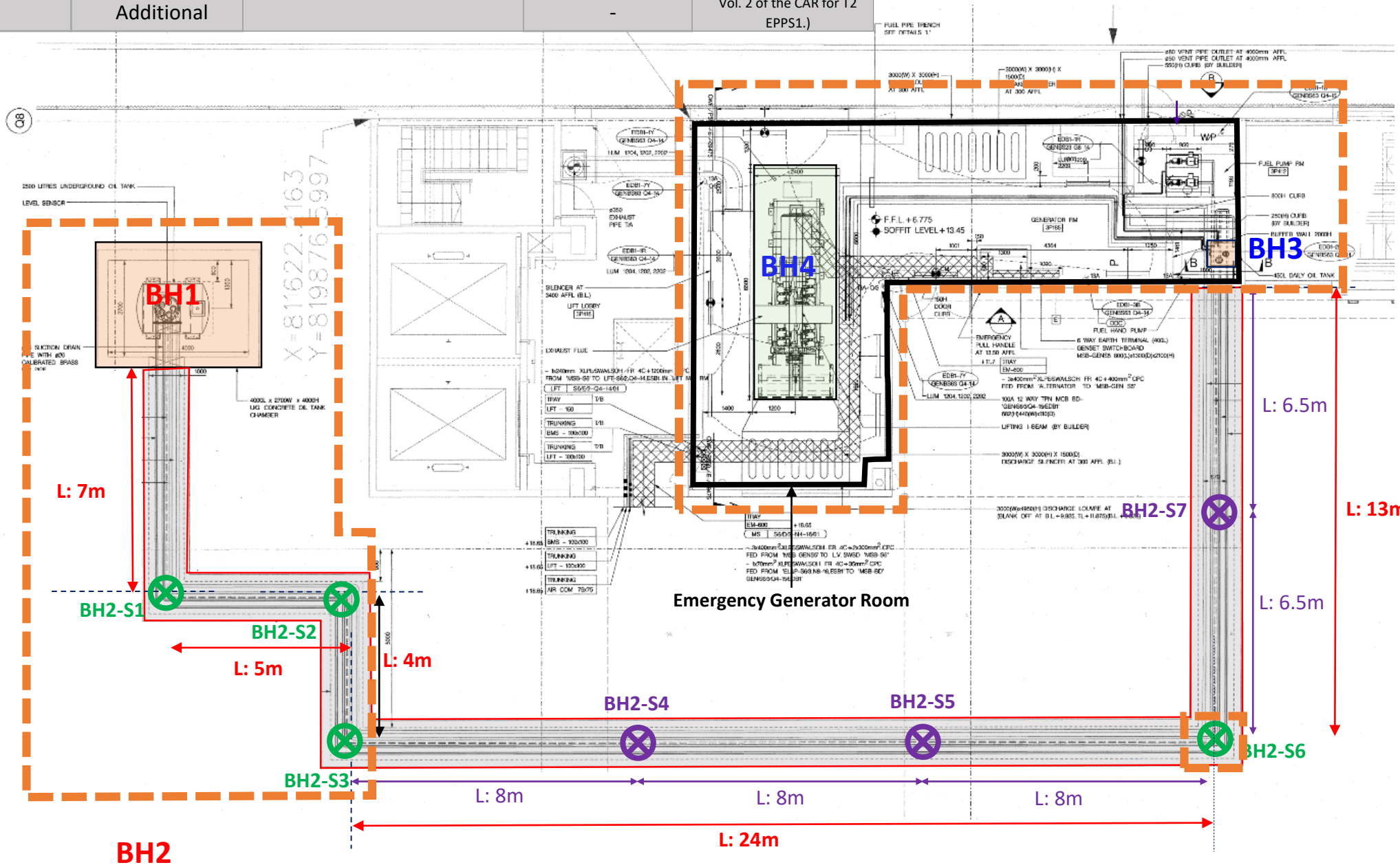

**BH2**  
Total Length: Approx. 53 m